

Connection Elements

Connection nipple for suction pad AN

Description

Connection nipple with outer thread for flat or bellows suction cups in steel, brass or aluminum design.

Application

- to clip on the suction cups. Easy exchange when worn out
- to prevent unintentional pulling off the cups can be equipped with clamps



ANF ... ANA

Article number

Type		Temperature (°C)	Weight (kg)
ANF-6-M5	1.31.1.0011	-10 ... +80	0,002
ANF-6-1/4	1.31.1.0012	-10 ... +80	0,002
ANF-8-M5	1.31.1.0013	-10 ... +80	0,010
ANF-8-1/4	1.31.1.0014	-10 ... +80	0,010
ANF-10-1/4	1.31.1.0026	-10 ... +80	0,012
ANF-16-1/4	1.31.1.0031	-10 ... +80	0,015
ANM-8-1/8	1.31.1.0032	-10 ... +80	0,008
ANM-13-1/4	1.31.1.0033	-10 ... +80	0,012
ANC-1,2-M5	1.31.1.0001	-10 ... +80	0,010
ANC-2,5-M5	1.31.1.0002	-10 ... +80	0,003
ANC-3,5-M5	1.31.1.0003	-10 ... +80	0,010
ANC-4-1/4	1.31.1.0005	-10 ... +80	0,020
ANC-4,5-1/4	1.31.1.0004	-10 ... +80	0,008
ANC-5-1/4	1.31.1.0007	-10 ... +80	0,024
ANC-5,5-1/4	1.31.1.0006	-10 ... +80	0,007
ANC-8-1/4	1.31.1.0008	-10 ... +80	0,008
ANA-9-1/8	1.31.1.0018	-10 ... +80	0,010
ANA-9-1/4	1.31.1.0019	-10 ... +80	0,018
ANA-29-1/4	1.31.1.0020	-10 ... +80	0,021
ANA-32-1/4	1.31.1.0021	-10 ... +80	0,027
ANA-41-1/4	1.31.1.0022	-10 ... +80	0,032

FEZER

Simply move more.

Connection Elements

Connection nipple for suction pad AN

FEZER

Simply move more.

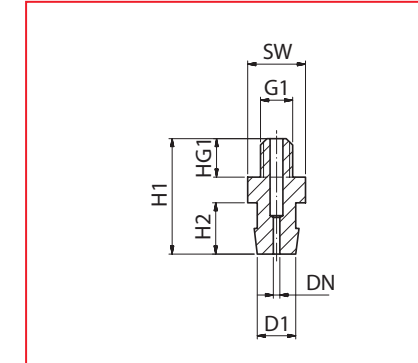

ANF-6-M5, ANF-6-1/4

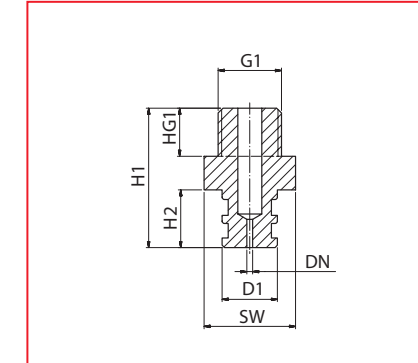

ANF-8-M5, ANF-8-1/4

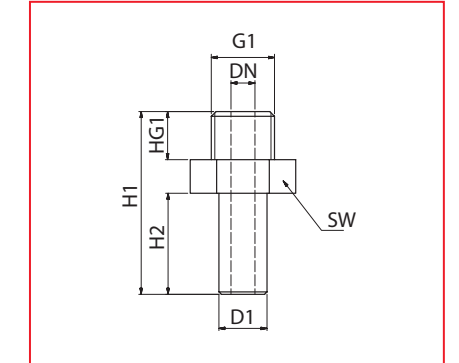

ANF-10-1/4, ANF-16-1/4

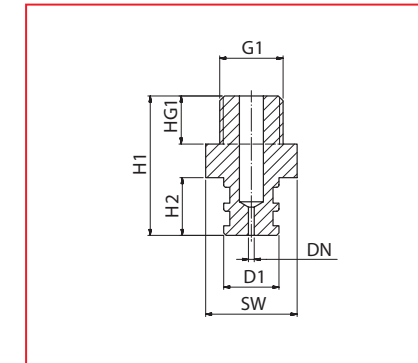

ANM-8-1/8, ANM-13-1/4

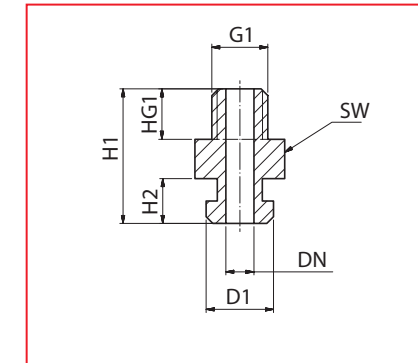

ANC-1,2-M5 ... ANC-8-1/4

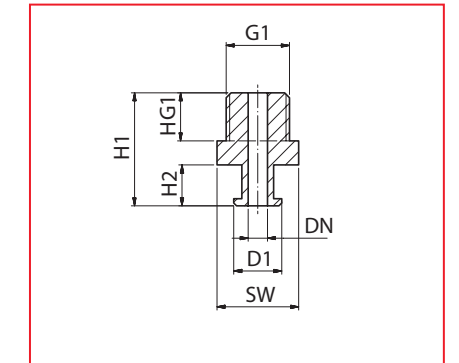

ANA-9-1/8 ... ANA41-1/4

Dimensions

Type	D1	DN	H1	H2	G1	HG1	SW
ANF-6-M5	7	1	18	8	M 5	6	9
ANF-6-1/4	7	4	25	8	G1/4	10	17
ANF-8-M5	11	1	18	12	M 5	6	---
ANF-8-1/4	11,5	5	29	12	G1/4	10	19
ANF-10-1/4	10	5	38	21	G1/4	10	19
ANF-16-1/4	16	5	38	21	G1/4	10	19
ANM-8-1/8	8	3,5	23	8,5	G1/8	7	14
ANM-13-1/4	13	6,5	25	9	G1/4	8	17
ANC-1,2-M5	3	1,2	10,5	2,5	M 5	4,5	8
ANC-2,5-M5	6	2,5	12	4	M 5	4,5	8
ANC-3,5-M5	6,5	3,5	13,5	6,5	M 5	4,5	8
ANC-4-1/4	10	4	23,5	8,5	G1/4	10	17
ANC-4,5-1/4	14	4	23,5	8,5	G1/4	10	17
ANC-5-1/4	14	5	29,5	14,5	G1/4	10	17
ANC-5,5-1/4	M10x1,25	5,5	25	10	G1/4	10	17
ANC-8-1/4	18	8	37	22	G1/4	10	17
ANA-9-1/8	7	3	21	5,5	G1/8	9,5	14
ANA-9-1/4	13	6	26	6	G1/4	10	17
ANA-29-1/4	12	6	29	12	G1/4	12	19
ANA-32-1/4	12	6	26	9	G1/4	12	19
ANA-41-1/4	12	6	46	10	G1/4	10	19