

Holder for Suction Pads

Holding bracket HSW

Description

Stable holder with upper connection thread and lateral vacuum feed made of galvanized steel. The connection screw is included.
 Holders with metric connection thread are designed for suction pads with body and are sealed by an o-ring.

Application

- used for limited space applications
- simple and quick installation
- mounted on suspension bolt for a lower vacuum connection

Article number

| Type | |
|-------------------|-------------|
| HSW-M12x1-M5 | 1.31.3.0012 |
| HSW-M12x1-1/8 | 1.31.3.0013 |
| HSW-M12x1-1/4 | 1.31.3.0014 |
| HSW-M16x1,5-1/4 | 1.31.3.0020 |
| HSW-M16x1,5-3/8 | 1.31.3.0021 |
| HSWO-M12x1-M8* | 1.31.3.0015 |
| HSWO-M16x1,5-M12* | 1.31.3.0016 |
| HSWO-M16x1,5-M16* | 1.31.3.0019 |

* design with o-ring sealing

Technical data

| Type | Tensile load max. (N) | Bending mom. max. (Nm) | Temperature (°C) | Weight (kg) |
|-------------------|-----------------------|------------------------|------------------|-------------|
| HSW-M12x1-M5 | 250 | 20 | -10 ... +80 | 0,09 |
| HSW-M12x1-1/8 | 250 | 20 | -10 ... +80 | 0,08 |
| HSW-M12x1-1/4 | 250 | 20 | -10 ... +80 | 0,16 |
| HSW-M16x1,5-1/4 | 600 | 60 | -10 ... +80 | 0,18 |
| HSW-M16x1,5-3/8 | 600 | 60 | -10 ... +80 | 0,18 |
| HSWO-M12x1-M8* | 250 | 20 | -10 ... +80 | 0,17 |
| HSWO-M16x1,5-M12* | 600 | 60 | -10 ... +80 | 0,18 |
| HSWO-M16x1,5-M16* | 600 | 60 | -10 ... +80 | 0,18 |

FEZER
Simply move more.



HSW-M12x1-M5 ... HSWO-M16x1,5-M16

Holder for Suction Pads

Holding bracket HSW

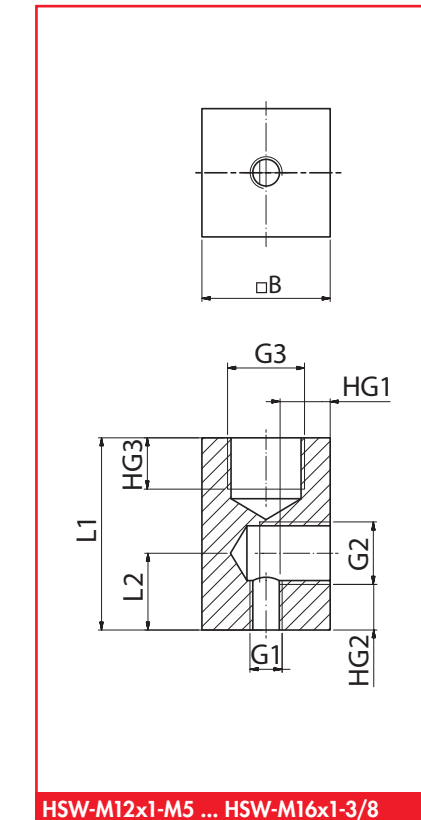

HSW-M12x1-M5 ... HSW-M16x1-3/8

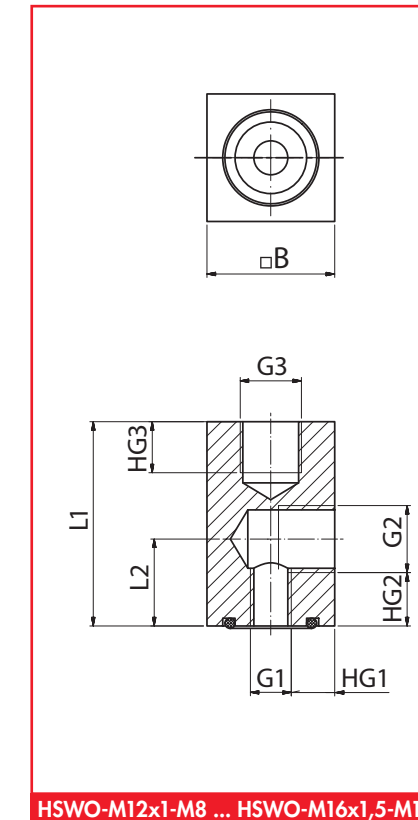

HSWO-M12x1-M8 ... HSWO-M16x1,5-M16

Dimensions

| Type | L1 | L2 | B | G1 | G2 | G3 | HG1 | HG2 | HG3 |
|-------------------|----|----|----|------|------|---------|-----|------|-----|
| HSW-M12x1-M5 | 30 | 12 | 20 | M5 | G1/8 | M12x1 | 7,5 | 7 | 10 |
| HSW-M12x1-1/8 | 35 | 15 | 20 | G1/8 | G1/8 | M12x1 | 5 | 10 | 10 |
| HSW-M12x1-1/4 | 40 | 17 | 25 | G1/4 | G1/4 | M12x1 | 6 | 10 | 10 |
| HSW-M16x1,5-1/4 | 50 | 22 | 25 | G1/4 | G1/4 | M16x1,5 | 6 | 15 | 12 |
| HSW-M16x1,5-3/8 | 50 | 22 | 25 | G3/8 | G3/8 | M16x1,5 | 6 | 13,5 | 12 |
| HSWO-M12x1-M8* | 40 | 17 | 25 | M8 | G1/4 | M12x1 | 8,5 | 10,5 | 10 |
| HSWO-M16x1,5-M12* | 50 | 22 | 25 | M12 | G1/2 | M16x1,5 | 6,5 | 11,5 | 12 |
| HSWO-M16x1,5-M16* | 50 | 22 | 25 | M16 | G1/2 | M16x1,5 | 4,5 | 11,5 | 12 |

FEZER
Simply move more.